

Operating instructions MINIROLL

automatic door systems – this is record!



record.group



record

your global partner for entrance solutions

Table of contents

1	General information.....	4
1.1	Product identification.....	4
1.2	Manufacturer ISEA FRANCE.....	4
1.3	Document identification.....	4
1.4	Important Notes.....	4
1.4.1	Copyright.....	4
1.4.2	Target groups (User).....	5
1.4.3	General definition of terms.....	5
1.4.4	Storage of the manual.....	7
2	Safety instructions and regulations	8
2.1	Presentation of warning signs.....	8
2.2	Product safety.....	9
2.2.1	State of the technology.....	9
2.2.2	Intended purpose of use.....	9
2.2.3	Residual risks.....	9
2.3	Danger zones.....	10
2.3.1	Danger warnings on the product.....	10
2.3.2	Qualifications, skills and training of staff.....	10
2.3.3	Reconstructions and changes to the product.....	10
2.4	Safety instructions.....	10
2.5	Power supply.....	11
3	Operating conditions.....	12
4	Product description.....	13
5	Operation.....	14
5.1	Push-button and key switch.....	14
5.1.1	Key operation.....	14
5.1.2	key switch.....	14
6	Procedure in case of MINIROLL malfunctions.....	15
7	Maintenance and regular inspection.....	16
8	Acceptance report.....	20

Table of contents

9	Maintenance log.....	21
10	Dismantling and disposal.....	23
11	EC declaration of conformity.....	24

1 General information

1.1 Product identification

For an exact identification please read the following data on the type plate, which is located on the inside of the casing or on the drive unit:

(Example)

Type:

Serial number:

Article number:

Mains connection:

Fuse protection:

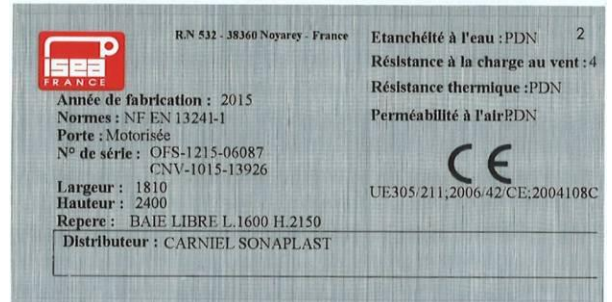

1.2 Manufacturer ISEA FRANCE

ISEA FRANCE

Route de Valence

Avenue St - Jean

F-38360 Noyarey

France

Phone: +33 4-76-53-99-99

Fax: +33 4-76-53-95-16

1.3 Document identification

Name: BAL_MINIROLL_EN_1V1_REC_119-001401011

Version: V1.1

Article No.: 119-001401011

1.4 Important Notes

1.4.1 Copyright

The copyright of the instructions remains at:

ISEA FRANCE

It is prohibited to reproduce, distribute or use the manuals for purpose of competition without authorization.

Violation of the here stated copyrights will be prosecuted and fined with compensation of damage.

Subject can change without prior notice. Differences between product and manual are thereby possible.

1.4.2 Target groups (User)

This operating manual is intended for the target groups listed below:

- Operating entity of the system:
the person who is responsible for the technical maintenance of this system
- Operator of the system:
the person who operates the system every day and has been suitably instructed

The handling of the system is explained with the help of this operating manual. It forms the basis of fault-free working and gives instructions for the procedures to follow for rectifying any faults that may occur. Extracts of this document can also be made accessible to persons entrusted with the day-to-day operation of the system.

The operating entity of the system must read this operating manual before commissioning the system, and follow the safety instructions.

It is recommended that this document should be kept handy in the vicinity of the automatic system.

1.4.3 General definition of terms

For better understanding, the following terms are used in the manuals:

Term:	Explanation:
System	A system is a gate supplied by ISEA FRANCE, F-38360 Noyarey. If any information in this manual applies exclusively to a specific gate type, this is specially mentioned in the text.
Manufacturer	ISEA FRANCE, FR-38360 Noyarey is described as the system's manufacturer.
Owner/operator	The owner/operator is the person or company who owns the system, regardless of whether the system is used by this person/company or by a third party. The owner/operator is responsible for ensuring the system's correct function and use.
Qualified personnel	Qualified persons have the necessary training, experience and instruction, as well as knowledge of relevant standards, regulations, accident prevention regulations and operating conditions, and have been authorized by the person responsible for the safety of the machine or system. They must perform the required tasks and recognize possible dangers and avoid them.
Competent person	A competent technical specialist, at least 16 years old, assigned by the manufacturer or his agent for assembly, commissioning, maintenance, and repair work.
Installation company	A competent technical person or company offering third-party installation services for these systems, including upgrades and electrical connections.

Shutter	A shutter consists of numerous exchangeable profiles, whose form enables them to be hinged together. Material: Galvanized or epoxy-coated steel
Gates without counterbalance	The shutter weight is not compensated by means of a spring mechanism. Gates without counterbalance open upwards.
P57 gates without counterbalance	Due to their low height, the profiles of the P57 gate are particularly attractive and are featured by minimum space requirements. Height: 57 mm. Thickness: 8-10 mm.
P97 (and P97 RUBIS) gates without counterbalance	Thanks to their curved shape, the P97 gate profiles are particularly strong (for intensive use and large widths). Height: 97 mm. Thickness: 7 or 9 mm.
P116 (and P116 RUBIS) gates without counterbalance	The P116 gate is ideally suited for all kinds of exterior openings (shops, industrial buildings, garages). Height: 116 mm. Thickness: 7 or 9 mm.
DP106 gates without counterbalance	Thanks to their dual-walled profiles with PU foam filling, DP106 gates offer good insulation properties. Heat transfer coefficient: $k=3.5 \text{ w/m}^2$
EUROLOOK gates without counterbalance	The transparent EUROLOOK shutter features a transparency of 83 % and a light transmittance of 92 % (UV-resistant).
BITUBO roller grilles without counterbalance	The BITUBO model features a specially modern design, and offers incomparable strength for large openings.
TUBONDA S roller grilles without counterbalance	The TUBONDA S model consists of curved tubes with diameters of 14 mm, and offers extensive visibility.
TUBONDA R roller grilles without counterbalance	The TUBONDA R model consists of curved tubes and horizontal reinforcing tubes with diameters of 14 mm, which are interconnected by means of safety fasteners. Interspaces of 45 mm ensure absolute safety.
Operated by continuous pressing (dead man mode)	The control button that moves the shutter to the required position (opening, stop, closing) must be pressed continuously while watching the shutter.
Impulse operation for opening, and dead man operation for closing	This operating mode complies with the impulse mode described in EN 13241-1.
ISO V.40 / ISO V.80 gates	Vertically opening gates, consisting of foamed polyurethane sections that are counterbalanced by means of springs.
Panorama gate	Vertically opening gates with sections made of aluminium profiles that are counterbalanced by means of springs.

1.4.4 Storage of the manual

After the installation of the system, the instructions should be stored in an accessible and dry place.

2 Safety instructions and regulations

2.1 Presentation of warning signs

Various symbols are used in this guide for easier understanding:



NOTICE

Useful advice and information to ensure correct and efficient workflow of the system.



IMPORTANT

Specific details which are essential for trouble-free operation of the system.



IMPORTANT

Important details which must be read for proper function of the system.



CAUTION

Against a potential hazardous situation that can lead to minor personal injury and property damage.



WARNING

Against a latent hazardous situation that can lead to severe injuries or death and cause substantial property damage.



DANGER

Against an imminent hazardous situation that can lead to severe injury or death.



DANGER

Against an imminent or latent hazardous situation that could lead to electric shock and cause serious injury or death.

2.2 Product safety

2.2.1 State of the technology

The installation has been constructed according to the latest technical knowledge and the recognised safety regulations. The installation complies with the requirements of European machinery directive 2006/42/EG as well as European standard NF EN 13241-1+A1 June 2011, NF EN 12604, NF EN 12453.

This conformity was established by means of prototype tests

Nevertheless, danger can arise if not used as intended.



IMPORTANT

Installation, maintenance and repairs to the installation must only be performed by qualified, trained and authorised technicians

A risk assessment has to be carried out for the whole installation.

2.2.2 Intended purpose of use

The system is intended to be used exclusively as a gate. This permits a wide range of application areas, as well as access by persons and vehicles. The system is intended for installation in industrial, commercial, and private premises.

Use of the system drive force for lifting persons, animals or loads is prohibited.

It is forbidden to use devices for the purpose of pressing or pushing against the system's drive force.

It is forbidden to modify the gate or its component parts.

It is forbidden to modify the electric control system in order to accelerate or reduce the gate's operating speed.

Any other use is considered to be non-intended use. The manufacturer bears no liability for any resulting damage; the owner/operator is solely responsible.

The intended purposes also include observation of the operating conditions specified by the manufacturer, in addition to regular care, maintenance and repair.

2.2.3 Residual risks

The system was designed according to the state of the art and recognized standards and guidelines. Nevertheless, improper use could endanger user safety and certain residual risks may not be avoided.



NOTICE

This device was not intended to be used by persons (including children) with limited physical, sensory or mental abilities, or with the absence of experience and/or lack of knowledge, unless they are being supervised by a person responsible for their safety or received instruction on how to use the device.

Children should be supervised to ensure that they do not play with the device.

2.3 Danger zones

2.3.1 Danger warnings on the product

If necessary, the country specific regulations have to be adhered to.

2.3.2 Qualifications, skills and training of staff

Mechanic	Technical training with very good electrical and mechanical skills Site experience
Commissioning employees Service employees	Technical training with very good electrical and mechanical skills Experience in field service

2.3.3 Reconstructions and changes to the product

Unauthorized modifications to the installation will release the manufacturer from all liability for any resulting damage.

2.4 Safety instructions



NOTICE

The system power must be turned off when doing inspection and maintenance work on electrical components.



IMPORTANT

All repairs and service work must be performed by qualified personnel. Technicians must have good general technical knowledge and a good knowledge of the current standards and regulations.



IMPORTANT

If malfunctions that endanger the safety of individuals occur, the system must be turned off. It may not be turned back on until the problem has been resolved by a professional and the danger no longer exists.



IMPORTANT

The gate may not be operated if any persons are within the gate's actuating area. Maintain a distance of at least 1 m from the gate.



IMPORTANT

To prevent injuries, the corresponding handle must always be used to open the gate manually.

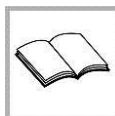

IMPORTANT

The gate must be opened completely to allow a vehicle to pass through.

**IMPORTANT**

If the gate's operation deviates from the description in this manual, or its functional safety is endangered due to faulty components, illegible pictographs or inadequate maintenance, please contact your supplier as soon as possible.

**IMPORTANT**

Corrosive and chemically aggressive ambient conditions (use of acids or leaches) can impair the gate's operational safety.

**IMPORTANT**

The removal of protective or safety devices, pictographs, or warning labels, as well as constructional modifications are strictly forbidden.

**IMPORTANT**

Wiring must be done in accordance with current national regulations, e.g. VDE.

**CAUTION****Fingers getting pinched**

- Fingers or hands getting crushed, sheared or pulled in
- Maintain at least 1 m distance during operation

**DANGER****Dangerous electrical voltage!**

- Risk of death by electric shock
- Do not touch the drive system when the system is turned on.
- Do not spray water into the drive.

2.5 Power supply

The power supply must be connected by a licensed electrician in compliance with the required safety class and degree of protection!

The cabling must be done according the french standard NFC 15-100 or according to the country specific regulations.

3 Operating conditions

The gate may not be operated under the following conditions:

- Temperatures below -30 °C
- Temperatures above +60 °C
- Wind pressure above 1100 Pascal (wind speed 110 km/h)
- The wind-up shaft may not be installed in the open during bad weather.
- The wind-up shaft must always be accessible for disassembly or maintenance.

4 Product description

The simple, robust, and flexible design of MINIROLL shutter doors, as well as the tightly rolled shutter permit a wide range of applications for access by persons and vehicles. MINIROLL shutter doors are intended for installation in industrial, commercial, and private premises.

The door is opened by means of a corresponding signal. e.g. from a:

- push-button
- key switch
- remote control
- crank handle

The opening signal causes the flexible shutter door to be rolled up. The drive is powered by an electric motor.

5 Operation

5.1 Push-button and key switch

The push-button serves for intentional door operation, and is located in a safe position for the operator at a height of 1.5 m above the ground. From this location, the operator must have a clear view of the system at all times.

On gate actuators with dead-man function, manual shutter operation must only be possible by means of control devices without self-holding.

5.1.1 Key operation

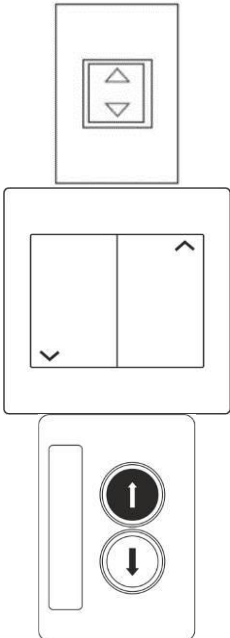
	<p>Gate open: The gate can be opened by pressing the push-button continuously. The shutter then moves upwards. If the push-button is released, the shutter stops.</p> <p>Gate close: The gate can be closed by pressing the push-button (continuously). The shutter then moves downwards. If the push-button is released, the shutter stops.</p>
--	--

5.1.2 key switch

The key switch serves for intentional gate operation, and is located in a safe position for the operator at a height of 1.5 m above the ground. From this location, the operator must have a clear view of the system at all times.

On gate actuators with dead-man function, manual shutter operation must only be possible by means of control devices without self-holding.

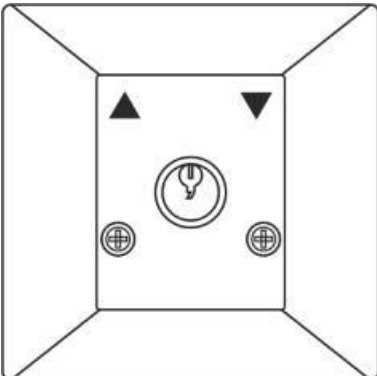
	<p>Gate open: The gate can be opened with the keyswitch by turning and holding the key. The shutter then moves upwards. If the key is released, the shutter stops.</p> <p>Gate close: The gate can be closed with the keyswitch by turning and holding the key. The shutter then moves downwards. If the key is released, the shutter stops.</p>
---	--

6 Procedure in case of MINIROLL malfunctions

The components of the shutter door have been designed for at least 50,000 cycles based on 4 operations per day.

Proceed as follows if a malfunction of the MINIROLL occurs:

Malfunctions	Possible cause	Remedial action
The shutter door stops immediately after starting operation	Fault in the safety catch device or the locking release catch	Please contact your supplier
Shutter is slanted	Connecting tabs loose or damaged	Please contact your supplier
Shutter stops moving before reaching its upper or lower end stop	End stop switches have become misaligned	Please contact your supplier

If the safety-catch device (roll-off protection) has been triggered, the shutter is blocked and cannot be moved. The safety-catch device must be released/replaced immediately by a qualified person.

7 Maintenance and regular inspection

General:



NOTICE

Any damage caused by non-observance of the operating and maintenance instructions or inadequate servicing, is not covered by our warranty. All maintenance work must be carried out by a qualified company.

Before first commissioning, and subsequently as required – and also according to applicable regulations, but at least **once per year** – a technical safety inspection must be carried out by a qualified service technician or an authorized partner.

The manufacturer recommends maintenance work to be done every 6 months. The operator must keep the inspection certificates, and make them available to the relevant authorities on demand.

Regular inspection and maintenance of the system by trained personnel authorized by the manufacturer is the best insurance for a long service life and trouble-free, safe operation.

Maintenance:



IMPORTANT

During maintenance work, suitable warning signs must be attached on both sides of the roller shutter door.

Disconnect the motor from the mains supply.

- Check the drive shaft alignment.
- Check the condition of the connecting tabs.

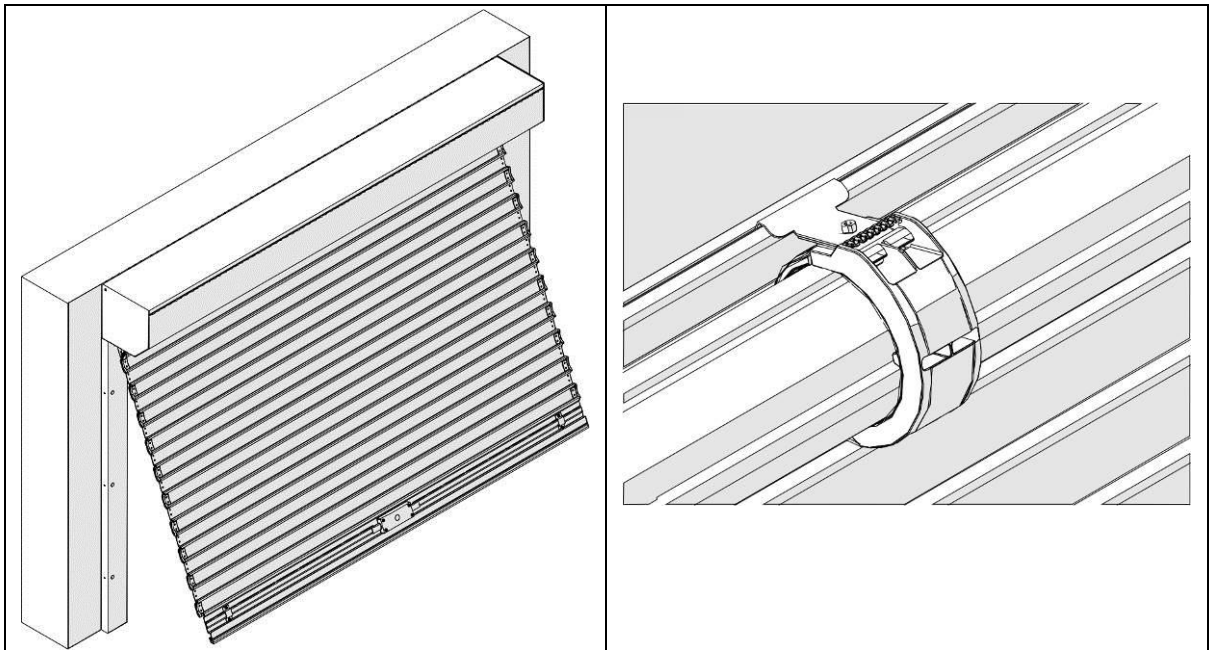

- Check the connection of the safety catch device.

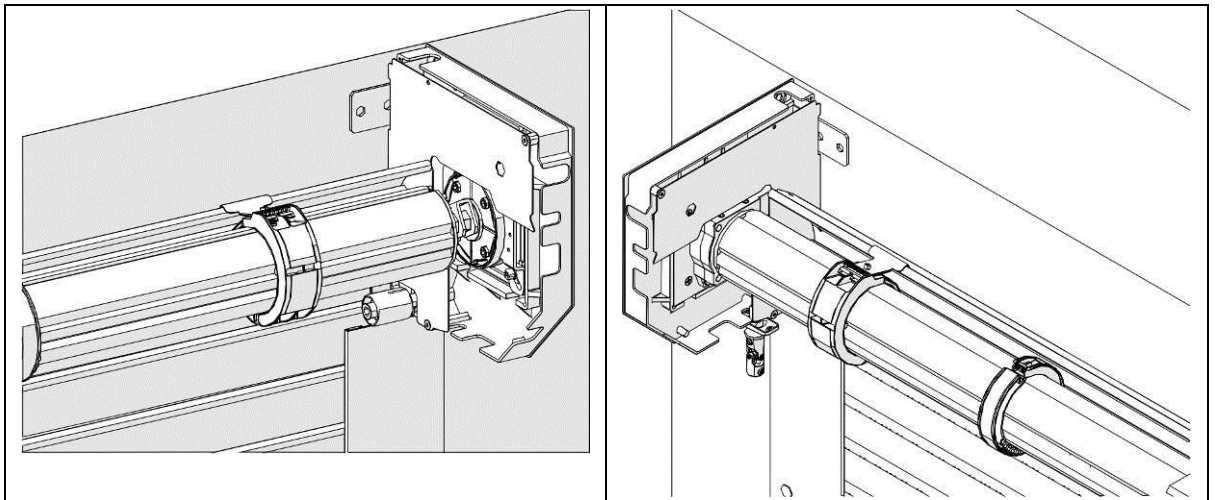

- Check the motor end stop adjustments.
- Check the shutter door mounting.

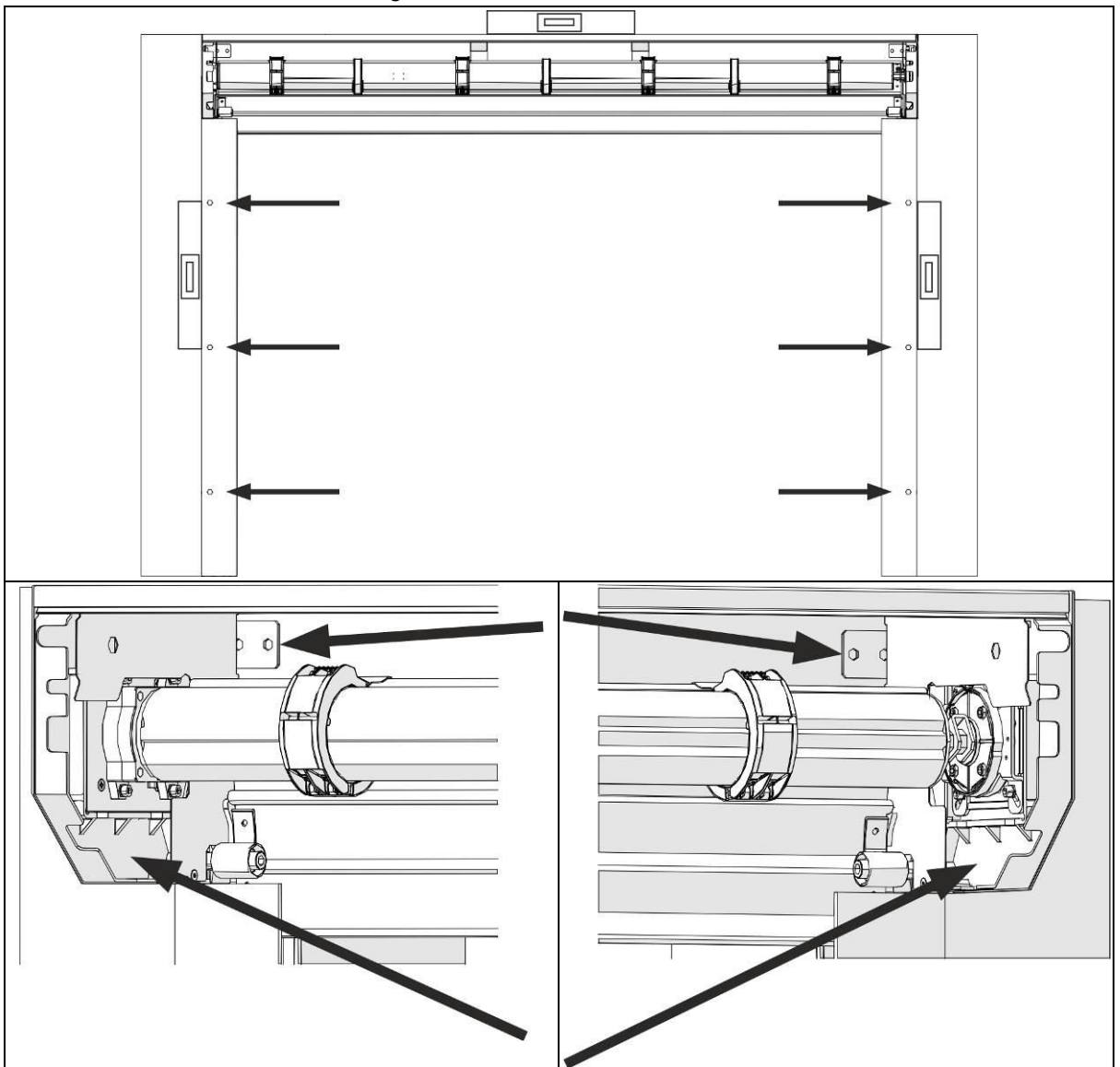

- Check the safety catch device mounting.

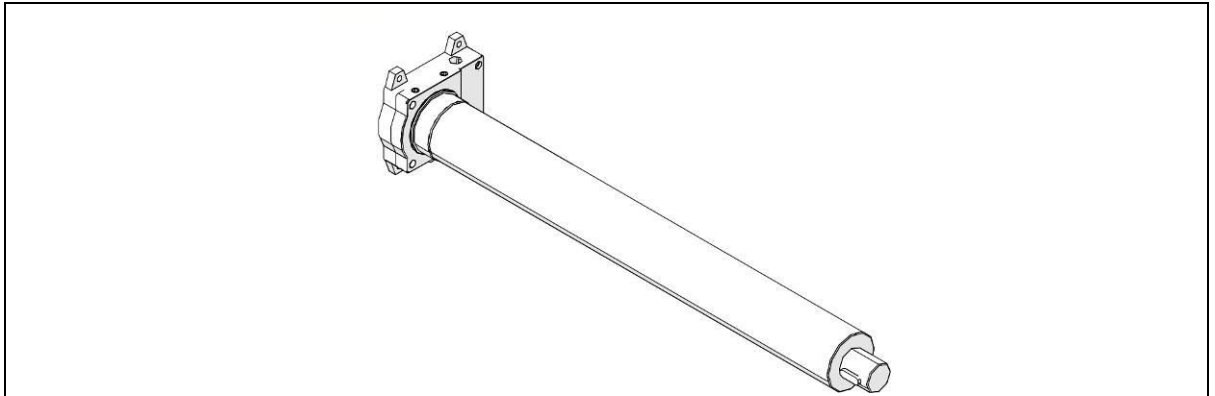

- Check the motor mounting.
- Clean the guide rails and flanges.
- Check the function of inside and outside emergency manual operating devices.
- Check the control unit function.

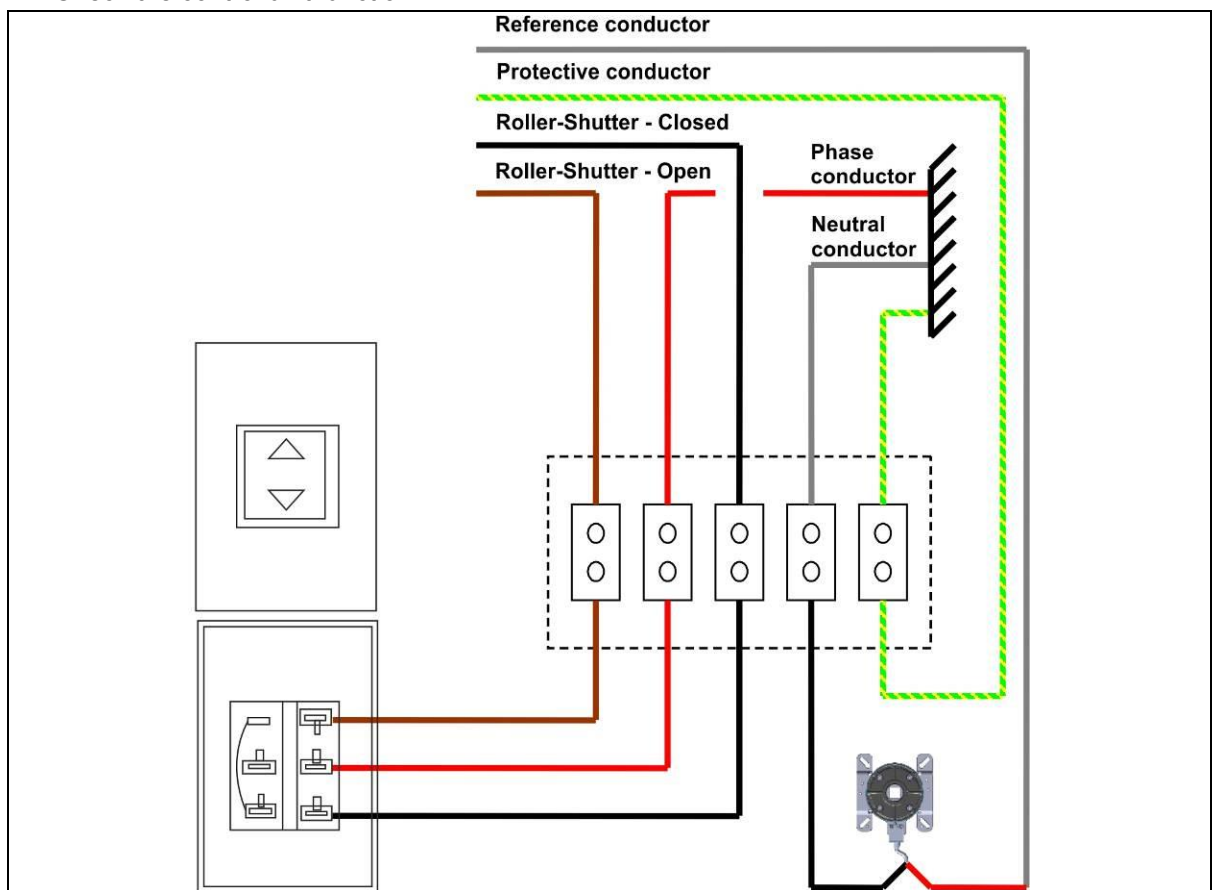

IMPORTANT

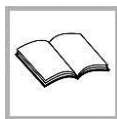

Make corresponding entries in the maintenance log with date and signature.
 Enter any repair work carried out.
 Have the maintenance log signed by the operating entity.
 Point out any faults or urgent repair work.

Inspection:

Check the shutter door for signs of damage from possible collisions.

Check the condition of the guide rails, and make sure that they are free of dirt or foreign bodies, which could restrict the shutter's free movement. These inspections are not normal maintenance work, but are checks that should be carried out regularly when inspecting and cleaning the workplace.

The operating person is obliged to carry out such an inspection every time before operating the shutter door.

Spare parts:

Spare parts can be ordered from your supplier. Only original spare parts must be used, and they must be fitted by a qualified installation company.

We recommend entering a servicing agreement with the service organization or authorized partner for your region.

**NOTICE**

Lubricate the guide rails and flanges regularly to ensure smooth and quiet operation.

**NOTICE**

At temperatures near the freezing point, all rubber seals must be protected with a thin coat of vaseline.

8 Acceptance report

Product description:	
Serial number:	
Address of operating entity/owner:	
Address of installation site:	
Checked:	
<input type="checkbox"/>	Product is complete and in good condition
<input type="checkbox"/>	Safety devices are in good condition
<input type="checkbox"/>	Installation has been done correctly
<input type="checkbox"/>	CE marking attached
<input type="checkbox"/>	Shearing points are protected or marked with warning labels
Remarks / notes:	
Delivery:	
<p>This document certifies the successful acceptance test of the product, and is the formal confirmation of delivery.</p> <p>By signing this document, the purchaser confirms:</p> <ul style="list-style-type: none"> ▪ that the product complies with his order; ▪ receipt of the operating and maintenance instructions, and that he has taken notice of his duties within the scope of the relevant standards as specified in the instructions; ▪ receipt of the troubleshooting instructions; ▪ receipt of the CE Certificate of Conformity (enclosed in this manual). <p>Date:</p> <p>Signed for the installation company:.....</p> <p>Signed for the operating entity/owner:.....</p>	

9 Maintenance log

Serviced on:	Comments:
By:	
Serviced on:	Comments:
By:	
Serviced on:	Comments:
By:	
Serviced on:	Comments:
By:	
Serviced on:	Comments:
By:	
Serviced on:	Comments:
By:	

Serviced on:	Comments:
By:	
Serviced on:	Comments:
By:	
Serviced on:	Comments:
By:	
Serviced on:	Comments:
By:	
Serviced on:	Comments:
By:	
Serviced on:	Comments:
By:	

10 Dismantling and disposal



IMPORTANT

All system components must be sorted, separated, and disposed of in accordance with the local and national regulations.

Amongst others, the system contains the following materials and components:

Aluminium:

- profiles
- drive gear housing
- various profiles and small parts
- drive covers

Steel / iron parts:

- drive housing
- possibly spacing or reinforcing profiles
- drive components, springs
- various small parts such as trolleys, threaded fittings, covers, linkage parts, etc.

various electronic and electro-mechanical components:

- sensors, controls, and drive components
- lead-acid and NC batteries

Various plastics:

- track rollers
- cable clips, clutch and linkage components
- sealing profiles
- housings of the electro-mechanical components and sensors

Liquids:

- lubrication oil (in the motor) must be disposed of as hazardous waste

11 EC declaration of conformity

Contact

→ **record UK limited**

Head Office: Unit D, 9 Watt Place – Hamilton International Park – Blantyre – G72 0AH – UK

Central Office: Batley Business Centre – Unit 40 – Annexe 2 – Technology Drive – Batley – WF17 6ER – UK

Southern Office: 17 Invincible Road – Farnborough – GU14 7QU – UK

tel.: +44 1698 376411 – fax: +44 1698 376422 – info@recorduk.co.uk – www.recorduk.co.uk

→ **record global export**

agtatec ltd – Allmendstrasse 24 – 8320 Fehraltorf – Switzerland

tel.: +41 44 954 91 91 – e-mail: export@record.global – www.record.global

→ **Headquarters**

agtatec ltd – Allmendstrasse 24 – 8320 Fehraltorf – Switzerland

tel.: +41 44 954 91 91 – e-mail: info@record.group – www.record.group



record

your global partner for entrance solutions

Subject to technical modifications – Copyright © agtatec ag
n°119.001401011 – Manufacturer: agtatec ag – Allmendstrasse 24 – 8320 Fehraltorf – Switzerland